

**5** 5 Years  
Product Warranty  
UK Only

**2** 2 Years  
On-Site Warranty  
Main-land UK Only



# Orda 2

07516 ORD03-WHT/ST

## Orda 2 Emergency twin-spot 3W Self-test White

- Trunk mount option and accessories included
- Non-maintained(3W)
- Twin fully adjustable heads allow best light coverage
- IP65, IK10
- Options of white and black finish

### Overview

The Orda LED Emergency Twin-Spot is a self-contained, high-power, robust, non-maintained emergency lighting solution available as standard or self-test versions. With two adjustable directional spotlights providing emergency illumination along exit routes for three hours during a power cut. Suitable for factories and industrial sites.

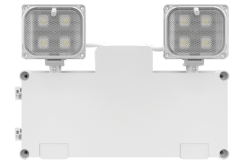

### General Information

IK Rating	IK10
IP Rating	IP65
Materials	Polycarbonate
Protection Rating	Class II
Installation Area	Internal and External
UEM/EME Protection	Class II

### Compliance

LVD	EN 60598-1:2024, EN 60598-2-22:2022, EN 62493:2015+A1:2022
EMC	EN 55015:2019+A11:2020, EN 61000-3-2:2019+A1:2021, EN 61000-3-3:2013+A1:2019+A2:2021, EN 61547:2023
Others	UKCA, CE, RoHS, WEEE, REACH

### Technical Summary

Product Code	ORD03-WHT/ST
Default Power	3 W
CRI	80
Lumens Output Maximum	370 lm
Maximum Efficiency	124 lm/W
Emergency Luminous Flux	370 lm
Maintained Luminous Flux	370 lm
Weight	0.68Kg
Dimensions (L x W x D) (mm)	261x184x78
UEM/EME Battery Life	4 y
UEM/EME Input Voltage	220-240Vac 50/60Hz
UEM/EME Ambient Temperature Range	0°C to 40°C
UEM/EME Power Factor	0.5
Emergency Modes	Maintained or Non-maintained
UEM/EME Test Function	Automatic Self-Test
UEM/EME CCT	6,500 K
UEM/EME Input Power (Max)	3.5 W
UEM/EME Protection	Class II
UEM/EME Dimensions (L x W x D) (mm)	261 x 184 x 78 mm (Wall mounting) 261 x 146 x 67 mm (Ceiling mounting)
UEM/EME Emergency Operation Test	Self-test (ATS Type S)
Beam Angle - Lumi (°)	110

Tel: 01635 523 713

Email: sales@kosnic.com

Kosnic.com



Kosnic Lighting KosnicUK KosnicLightingUK

**5** 5 Years  
Product Warranty  
UK Only

**2** 2 Years  
On-Site Warranty  
Main-land UK Only

# Orda 2



07516 ORD03-WHT/ST

## Accessories

Product Code	Description	Type
BAT18LFP2/L	Battery for Emergency sign DALI of MULU NITRO DOXA ORDA 3W	Battery

## Overview

The Orda LED Emergency Twin-Spot is a self-contained, high-power, robust, non-maintained emergency lighting solution available as standard or self-test versions. With two adjustable directional spotlights providing emergency illumination along exit routes for three hours during a power cut. Suitable for factories and industrial sites.



## General Information

IK Rating	IK10
IP Rating	IP65
Materials	Polycarbonate
Protection Rating	Class II
Installation Area	Internal and External
UEM/EME Protection	Class II

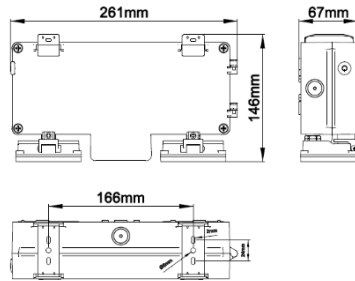

## Ceiling Mounting

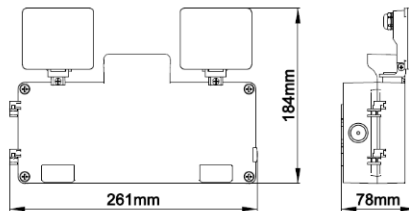

## Wall Mounting

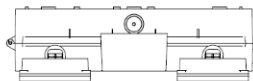

Tel: 01635 523 713

Email: [sales@kosnic.com](mailto:sales@kosnic.com)

[Kosnic.com](http://Kosnic.com)



Kosnic Lighting KosnicUK KosnicLightingUK KosnicUK